



CEMPROTEC 2000-S

Flexible Waterproof Sealing Tape

USES

CEMPROTEC 2000-S is an advanced, elastomeric, highly tear resistant, breathable, waterproof composite tape, which is embedded in the **CEMPROTEC** range of cementitious coatings to give a highly flexible, impermeable seal over “live” cracks and expansion or construction joints in waterproofing applications.

ADVANTAGES

- Permanently elastomeric composite tape exhibiting over 600% elongation.
- Used in conjunction with Flexcrete’s range of **CEMPROTEC** cementitious coatings to enable rapid application.
- Excellent weathering resistance and highly tolerant of a wide range of chemicals.
- Impermeable to water under 10 bar hydrostatic pressure (100m head of water).
- Non toxic and suitable for indirect contact with potable water. WRAS Approved.

COMPATIBLE COATINGS

CEMPROTEC 2000-S can be used in conjunction with the following range of **CEMPROTEC** cementitious coatings available from Flexcrete:

CEMPROTEC CEMENTITIOUS COATING 851
CEMPROTEC E-FLOOR

CEMPROTEC E942
CEMPROTEC E-FLOOR HB

CEMPROTEC ELASTIC

PREPARATION

The areas to be treated must be free from all unsound material, i.e. dust, oil, grease, corrosion by-products and organic growth. Smooth surfaces should be roughened, all loose material and surface laitance removed, and steel cleaned to bright metal preferably using wet grit or water blasting techniques or equivalent approved methods. The strength of the concrete sub-base should be a minimum of 20 MPa. Ensure all surfaces are fully saturated but free from standing water.

PRIMING

Seal floors and deck areas using **CEMPROTEC EF PRIMER**. See relevant data sheet.

PLACING

Apply 25mm wide masking tape centrally over the crack or joint before applying, by brush, a 1mm thick coat of **CEMPROTEC E942** or **CEMENTITIOUS COATING 851** extending a minimum of 20mm beyond the edges of the reinforcing tape. Uniformly embed **CEMPROTEC 2000-S** using a brush, trowel or similar, ensuring there are no wrinkles. Leave until stable and apply a final 1mm coat of **CEMPROTEC** cementitious coating encapsulating the **CEMPROTEC 2000-S** as shown in the detail drawings. In applications where a high degree of movement is expected apply **CEMPROTEC ELASTIC** as the top coat.

Over expansion joints, leave additional slack in the tape to allow for the designed degree of joint movement. An optional second tape can be installed where additional protection is required.

APPLICATION DATA

Application Guide available on request.

COMPLIANCE

WRAS approved.

TECHNICAL DATA

Basis:	Elastomeric membrane embedded in backing fabric
Colour:	White
Sizes:	12cm wide 10m long roll 12cm wide 50m long roll 20cm wide 50m long roll
Thickness:	0.4mm
Elongation:	Typically 600% (ASTM D-638)
Joint Movement:	Typically 100% of joint width
Impermeability:	Resists 10 bar water pressure
Temperature Range:	-20°C to +90°C.

TAPE JOINTS & OVERLAPS

Create joints or overlaps, e.g. at tape intersections, using a 100mm length of **CEMPROTEC 2000-BJT** self-adhesive butyl strip, cut to width. Use a hard roller to achieve full bond. Alternatively, join a second length of tape to the top of an adhered tape by applying 1mm of Flexcrete cementitious coating with a 100mm overlap. **CEMPROTEC ELASTIC** should not be used for this procedure.

STORAGE

Store in dry conditions in original packaging.

SAFETY DATA

Safety Data Sheet available on request.

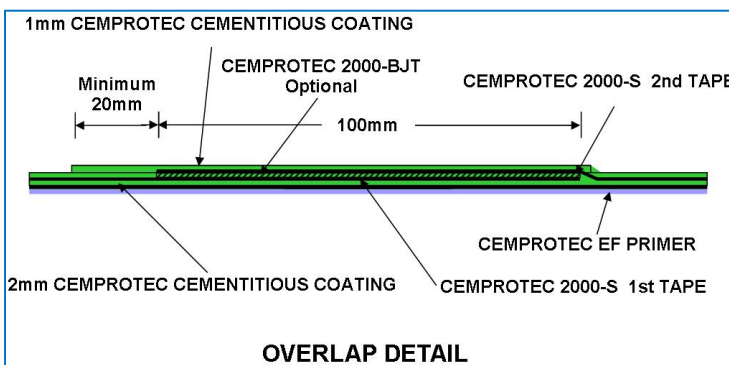
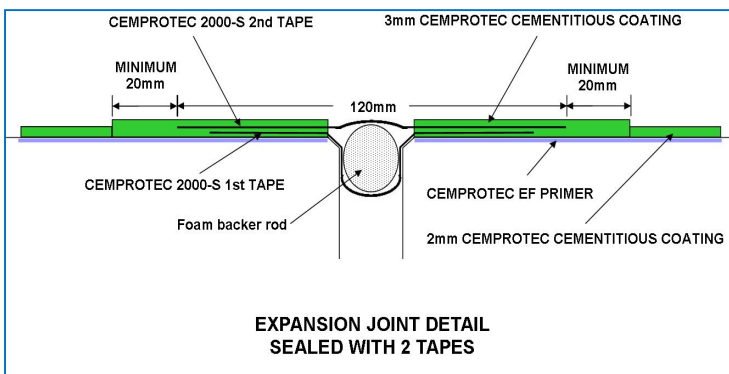
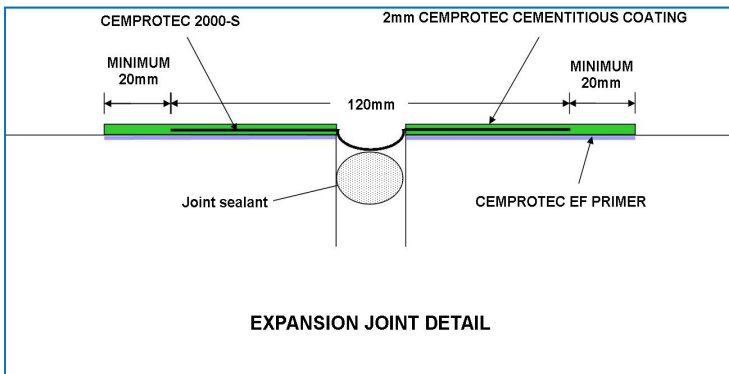
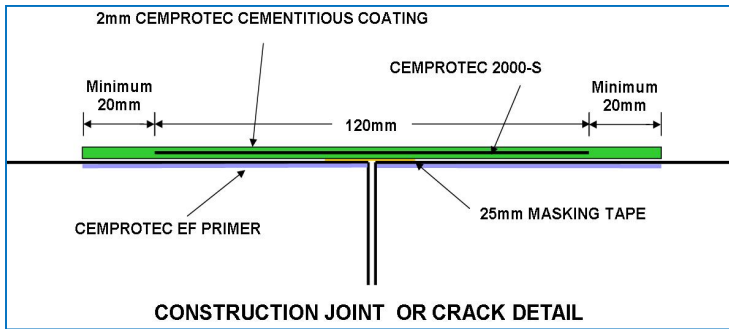
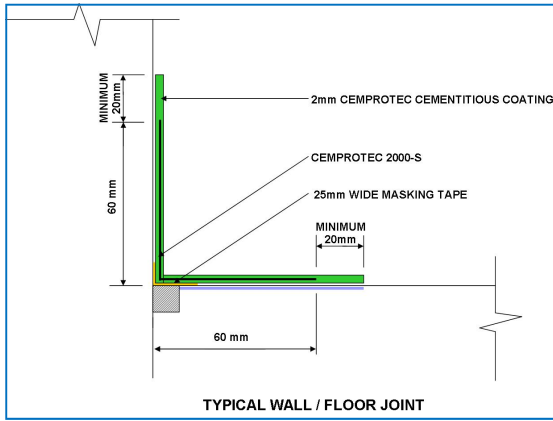
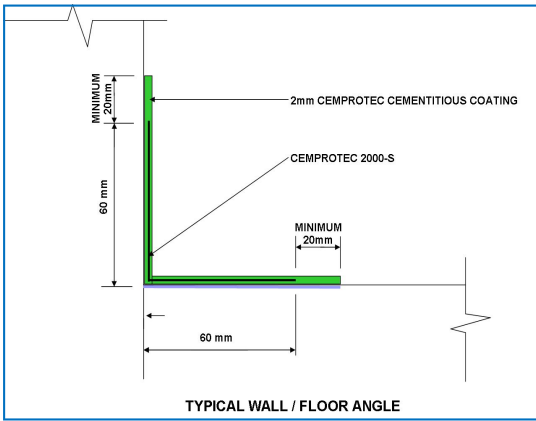

Flexcrete Technologies Limited
Tomlinson Road
Leyland
Lancashire
PR25 2DY
United Kingdom
Tel: +44 (0) 845 260 7005
Fax: +44 (0) 845 260 7006
Email: info@flexcrete.com
Web: www.flexcrete.com



FM 41091
EMS 597350
OHS 597351
Quality
Environmental
Health & Safety