

## Peep Vent

### Description

The Peep Vents functionally provides cavity wall drainage with an inconspicuous "peep" profile on the brick wall face. The design features ribbing to act as a mortar key for secure flooring, and a small angled exit hole to facilitate water drainage whilst guarding against penetration of insects and wind driven rain.

### Fitting instructions

The Peep Vent is fitted in open perp joints and mortared in position leaving 10mm proud of the brick face. N.H.B.C guidelines and peep holes are recommended to be sited at every 450mm with at least two per opening above all windows and doors.

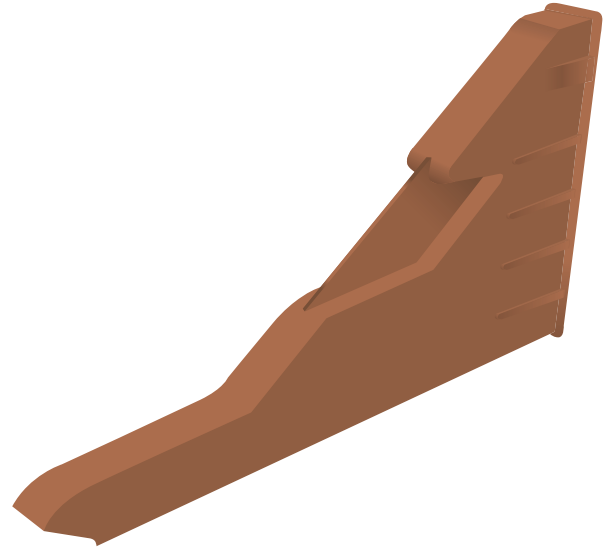
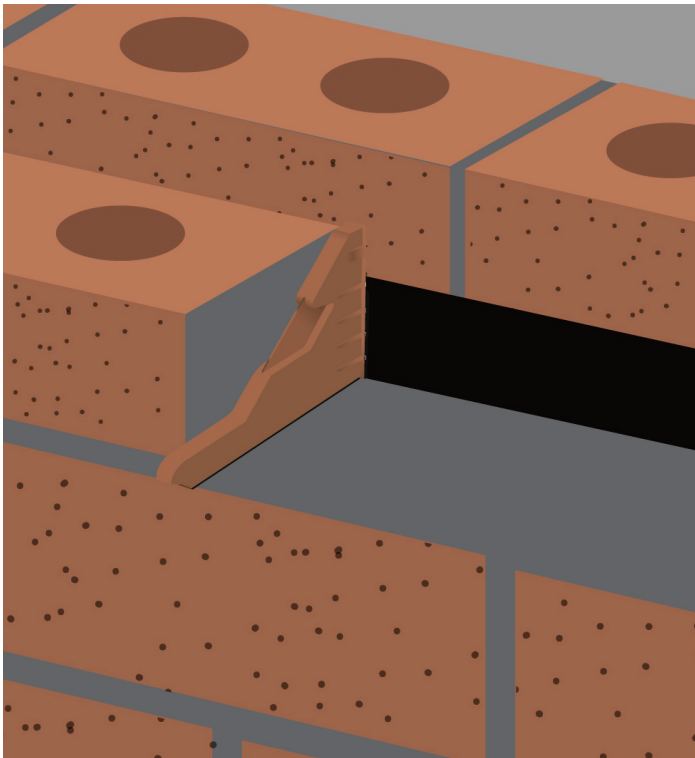

Product Code	Description	Box Qty
SOLCO/PEEP/BLACK	Peep Weep Black	100
SOLCO/PEEP/CLEAR	Peep Weep Clear	100
SOLCO/PEEP/TERRA	Peep Weep Terracotta	100
SOLCO/PEEP/BUFF	Peep Weep Buff	100

### Technical

Colour: Terracotta, Clear,  
Buff, Black

Box Qty: 100

Material: Polypropylene

