

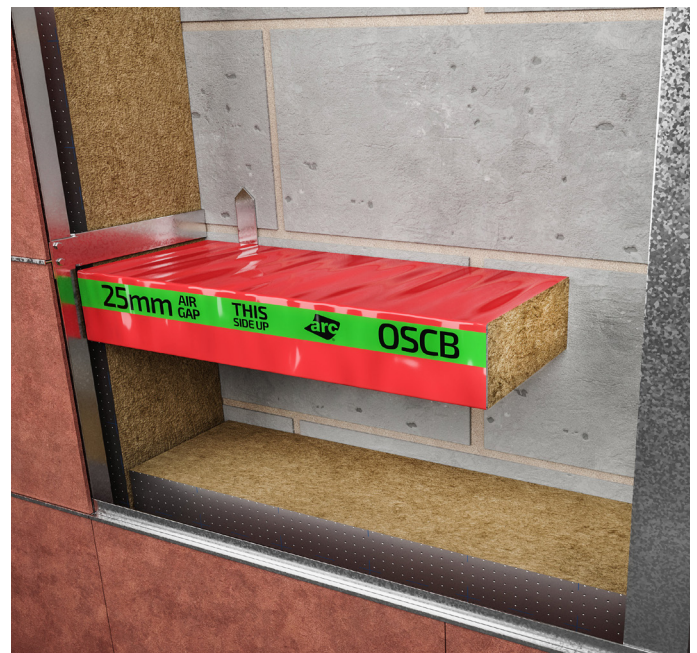

# OPEN STATE CAVITY BARRIER

Open state cavity barrier for ventilated cavities

- » Reactive intumescent element
- » Either 60min or 120min fire integrity
- » 25mm or 44mm air gap for ventilated cavity
- » Tested to ASFP TGD19 standards
- » Fixing brackets included as standard
- » Suitable for use horizontally



# OPEN STATE CAVITY BARRIER



## Description

ARC OSCB cavity barriers are designed for installation within cavities where ventilation is required in service use. Manufactured from non-combustible rockfibre mineral wool with a reactive intumescent layer, the cavity barrier can provide an air gap of up to either 25mm or 44mm.

The intumescent layer will rapidly expand when exposed to heat in a fire event, closing off the air gap and preventing vertical fire spread within the external wall cavity.

Suitable for installation horizontally, ARC OSCB open state cavity barriers should be partnered with ARC Fire Stop Slab installed vertically for a complete cavity barrier solution.

## Product Specification

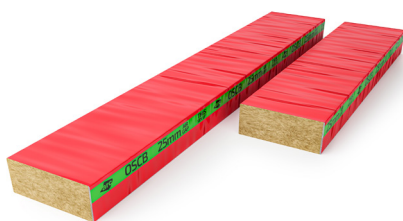

Product Range	Cavity Widths Available	Max. Air Gap	Colour	Fire Performance		Dimensions	Fixing Method
				Integrity	Insulation		
OSCB25	40 – 450mm	25mm	Red with green strip	60 mins	60 mins	Depth : Cavity width less 25mm Thickness: 75mm Length: 1200mm	ARC Pigtail Screw + ARC OSCB Fixing Bracket
OSCBPLUS25	40 – 300mm	25mm	Red with blue strip	120 mins	120 mins	Depth : Cavity width less 25mm Thickness: 75mm Length: 1200mm	ARC Pigtail Screw + ARC OSCB Fixing Bracket
OSCB44	60 – 300mm	44mm	Red with yellow strip	60 mins	60 mins	Depth : Cavity width less 44mm Thickness: 75mm Length: 1200mm	ARC OSCB Fixing Bracket only

Notes: see separate fixing details for specific bracket specification relevant to cavity width and barrier type.

Please contact us for requirements outside of these ranges. Non standard details, sizes and test data may be available.

## Design Considerations

Air gap specified is maximum allowable. This is the space between the front of the cavity barrier and rear side of the outer substrate, and should take in to account any contours, shapes, or profiles in the external wall system. Consider over specifying where material or build tolerance is a concern.

The cavity barrier must run continuously and uninterrupted apart from where it abuts the vertical cavity barrier. It must not be penetrated by other elements including mechanical or electrical services.

Any information provided within this document is intended for guidance only. Expert technical advice should be sought before specification or installation of any product. It is of particular importance to ensure that any fire barrier or fire stopping product is tested for use with the exact application intended. ARC Building Solutions Ltd cannot accept liability for failure where usage is outside of the standard application, including but not limited to, where deflection or distortion has allowed gaps to form around the barrier, or where the barrier is not fitted in accordance with the manufacturer's guidelines.

© 2021 ARC Building Solutions Ltd. ARC and T-Barrier are registered trademarks of ARC Building Solutions Ltd.



Certificate Number 19310  
ISO 9001, ISO 14001  
ISO 45001